

The Estate Agents People Recommend



19 The Grove, Twyford, Berkshire, RG10
9DU

Price guide £435,000

Wentworth Estate Agents have pleasure in offering to the market a THREE BEDROOM MID TERRACE HOUSE WITH GARAGE within the heart of the village centre and a short walk from the village shops, coffee shops, Waitrose, Tesco and Twyford mainline train station serving London Paddington and Reading. The Elizabeth line is also linked to Twyford station.

Ground floor accommodation comprises of entrance hall, large living/ dining room with patio door to the garden, kitchen with plenty of eye and base level units.

First floor accommodation comprises of master bedroom with fitted wardrobes, second bedroom with fitted wardrobes, a further bedroom with storage and family bathroom with bath and shower over, WC and wash hand basin.

Further benefits include gas central heating, garage, rear garden with shed and access to the garage at the rear, within the centre of Twyford, walking distance to all amenities.

EPC - D



t: 0118 934 0027

e: twyford@wentworthea.com

w: wentworthea.com



GROUND FLOOR
374 sq.ft. (34.8 sq.m.) approx.

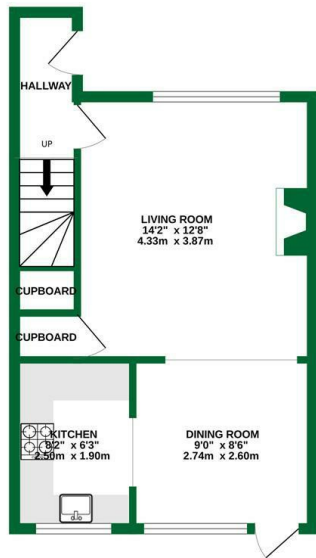

1ST FLOOR
365 sq.ft. (33.9 sq.m.) approx.

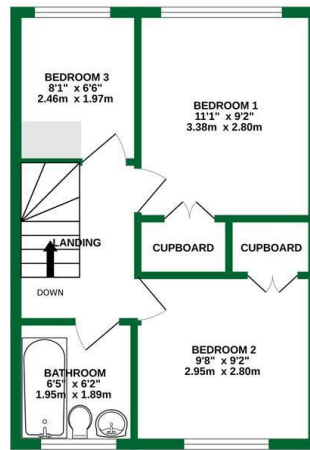

TOTAL FLOOR AREA: 740 sq.ft. (68.7 sq.m.) approx.

Whilst every attempt has been made to ensure the accuracy of the floorplan contained here, measurements of doors, windows, rooms and any other items are approximate and no responsibility is taken for any error, omission or mis-statement. This plan is for illustrative purposes only and should be used as such by any prospective purchaser. The services, systems and appliances shown have not been tested and no guarantee as to their operability or efficiency can be given.
Made with Metropac 02023

Important Notice 1. Particulars: These particulars are not an offer or contract, nor part of one. You should not rely on statements by Wentworth Estate Agents in the particulars or by word of mouth or in writing ("information") as being factually accurate about the property, its condition or its value. Neither Wentworth Estate Agents nor any joint agent has any authority to make any representations about the property, and accordingly any information given is entirely without responsibility on the part of the agents, seller(s) or lessor(s). 2. Photos etc: The photographs show only certain parts of the property as they appeared at the time they were taken. Areas, measurements and distances given are approximate only. 3.Regulations etc: Any reference to alterations to, or use of, any part of the property does not mean that any necessary planning, building regulations or other consent has been obtained. A buyer or lessee must find out by inspection or in other ways that these matters have been properly dealt with and that all information is correct.

